

Tucson Model #8700

Direct Vent Gas Stove Heater

Exploded Parts Drawing Revision 0.6

(from Serial #014382)

Production Dates: April 1997 -

Serial#: 001001 -

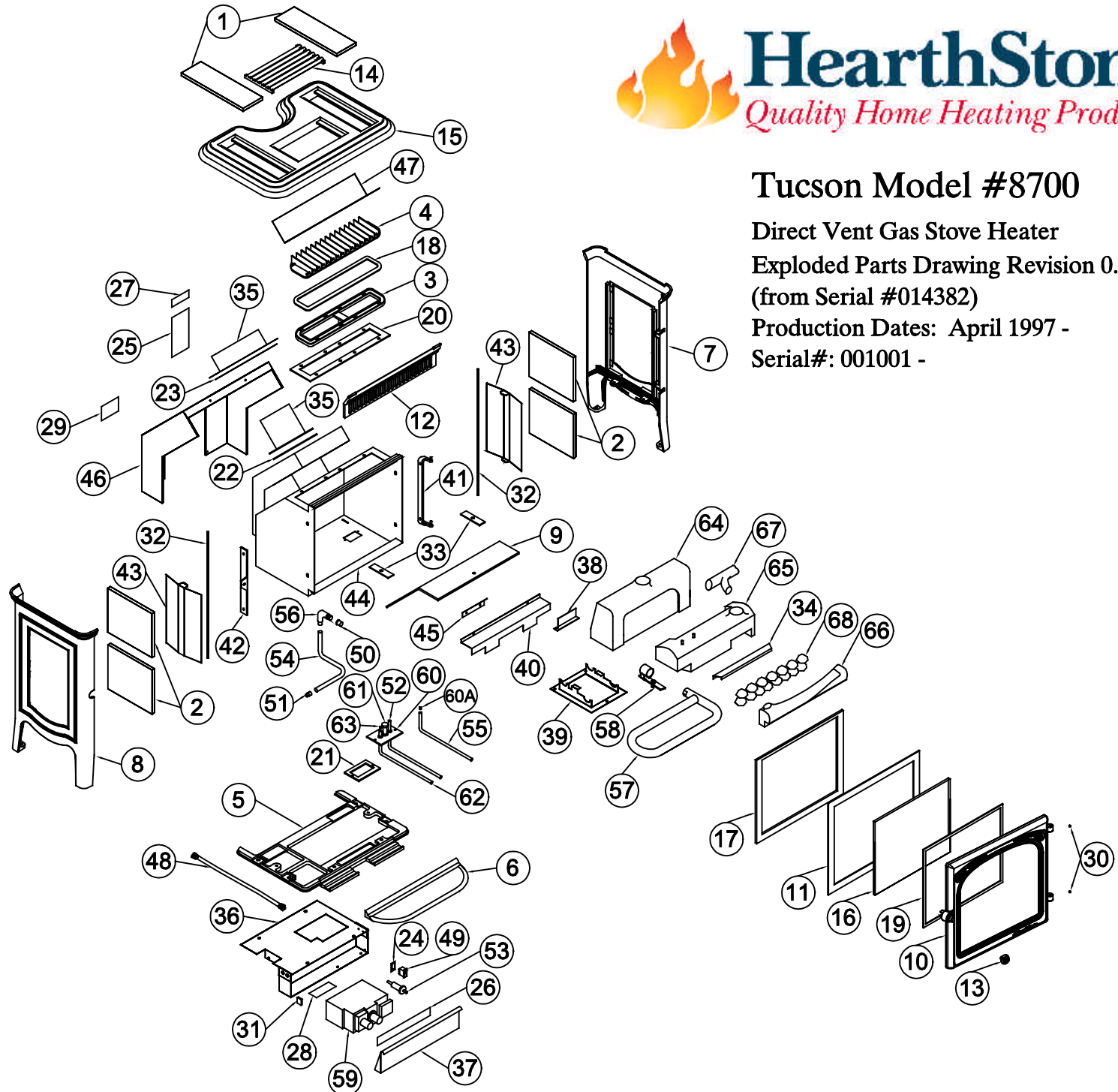



Model: Tucson Direct Vent #8700

Production Dates: April 1997 -

Serial #: 001001 -

[Link to Parts Pricelist](#)

Note: Color must be specified for cast iron parts which are available in enamel.

Key	Part #	Description	
1	1741-350	Top Stone 3 5/16" x 10 5/16"	Must specify stone color
2	1741-351	Side Stone 7 1/2" x 6 1/2"	Must specify stone color
3	2310-850	Heat Exchanger Base	
4	2310-860	Heat Exchanger	
5	2710-116	Bottom Casting	
6	2710-220	Ashlip	
7	2710-321	Right Side Casting	
8	2710-326	Left Side casting	
9	2710-480	Firebox Baffle - Cast	
10	2710-511	Door	
11	2710-560	Glass Retainer Frame	
12	2710-581	Front Grill	
13	2710-655	Door Handle	
14	2710-810	Top Grill Plate	
15	2710-815	Top Casting	
16	3030-027	Glass 13 1/4" x 11 1/4" x 5mm	
17	3110-057	(4.6') 3/8" Gasket	
18	3160-075	Gasket: Heat Exchanger	
19	3160-090	Gasket Tape 3/4" x 1/16"	
20	3160-150	Heat Exchanger Base Gasket 4" x 14 1/2"	
21	3160-152	Pilot Gasket	
22	3160-155	Exit Gasket 4" x 6"	
23	3160-157	Inlet Gasket	
24	3300-334	Label: On/Off/T-Stat	
25	3300-500	Safety Rating Label	
26	3300-502	Lighting Instruction Label	
27	3300-504	Vent Warning Label 3 1/16" x 1 1/4"	
28	3300-506	Installation Warning Label	
29	3300-510	Fuel Conversion Label	
30	4700-0605	Hinge Cap Plugs 3/16" ID x 11/16" OD	
31	4700-0795	Access Door Magnet	
32	5210-3070	Threaded Rod 1/4-20 x 19"	
33	5300-118	Blast Limiter	
34	5320-070	Ember Support Screen Serial #<015612	
35	5701-924HB	Inlet/Exit Collar	
36	5710-121	Valve & Ignitor Bracket	
37	5710-128	Access Door	

38	5710-141	Pilot Shield
39	5320-072	Burner Tube Holder Serial #>015612
	5710-152	Burner Tube Holder Serial #<015612
40	5710-160	Air Intake Flap
41	5710-170	Hinge Bracket
42	5710-180	Latch Bracket
43	5710-470	Stone Clip
44	5710-514	Firebox
45	5710-594	Baffle Chip
46	5710-596	Rear Shroud
47	5710-598	Rear Shroud Extension
48	7000-032	On/Off/T-Stat Wire Harness
49	7000-200	On/Off/T-Stat Switch
50	7200-240	Burner Orifice NG #40
51	7210-007	Fitting 3/8" NPT x 3/8" Compression
52	7210-090	Thermopile
53	7210-103	Piezo Igniter
54	7211-005	3/8" Manifold Supply Tube
55	7211-009	Pilot Tube w/fittings
56	7211-020	90 degree elbow 1/8"NPT x 3/8"CMP
57	93-80200	Burner Tube Serial # = and > 015612
		Includes:
	4400-0200	(4)1/8" x1/8" Blind Rivets
	5320-075	Left Ember Screen
	5320-077	Right Ember Screen
	7211-232	"S" Burner Tube Serial # >015612
57	7211-225	Burner Tube Serial # 1001 - 13888
57	7211-228	Burner Tube Serial #013889 - 015611
58	7211-231	Air Shutter Serial #>005302
59	7211-320	SIT Univ. Valve NG 50% Turn Down
60	7211-370	3-Way Top Convertible Pilot Assy. NG
60A	7211-163	Pilot Orifice NG .62mm
61	7211-390	Pilot Hood - 3 way - Top Convertible
62	7211-430	Ceramic Electrode
63	7211-470	Thermocouple
64	7211-554	Rear Log Serial #<013889
65	7211-555	Middle Log Serial #<013889
66	7211-556	Front Log Serial #<013889
67	7211-557	Top Log Serial #<013889
68	7211-558	Ceramic Embers

97-81200 Burner/Log Upgrade Kit Serial #'s between 013889 - 015612
Includes:
93-66200 Log Set
93-80200 Burner Tube
5320-072 Burner Tube Holder
93-66200 Log Set Serial #>013889
Includes:
7211-560 Main Log
7211-561 Twig
7211-558 Ceramic Embers
90-56920 Wall Thermostat Kit
Includes:
7000-015 40' 18/2 Thermostat Wire
7200-506 Millivolt Wall Thermostat
93-56200 NG Conversion Kit Top Convertible Serial #>012760
Includes:
7200-240 #40 NG Burner Orifice
7211-163 .62mm NG Pilot Orifice
7211-312 NG Regulator 50% Turn Down
93-56906 NG Conversion Kit Serial #<012760
Includes:
7200-240 #40 NG Burner Orifice
7211-151 .51mm NG Pilot Orifice (Drop Down)
7211-312 NG Regulator 50% Turn Down
93-56201 LP Conversion Kit Top Convertible Serial #>012760
Includes:
7200-253 #53 LP Burner Orifice
7211-131 .30mm LP Pilot Orifice
7211-313 LP Regulator 50% Turn Down
93-56907 LP Conversion Kit Serial #<012760
Includes:
7200-253 #53 LP Burner Orifice
7211-130 .30mm LP Pilot Orifice (Drop Down)
7211-313 LP Regulator 50% Turn Down